

K2 POWER E 30 KX 12" Subwoofer



- K2 Power sandwich cone
- Aluminum basket
- Dual voice coil (2x40hms)

SPECIFICATIONS

Nominal power	600W RMS	
Maximum power	1200W	
Sensitivity (2.83V/1m)	90dB	
Cone	Kevlar sandwich	
Surround	Butyl	
Nom. impedance	4+4 Ω	
DC resistance	3.2+3.2 Ω	
VC diameter	65mm	2 ^{9/16"}
Former	Glass fiber	
Layers	4	
Wire	CCAW	
Net weight	11.2kg	24.7lbs

FREQUENCY RESPONSE

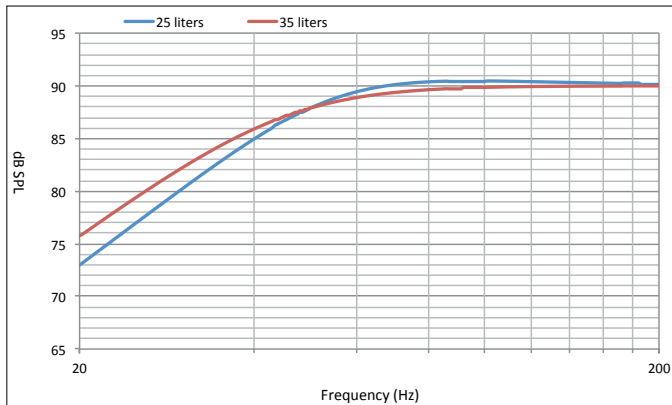

PARAMETERS

Rdc	3.2+3.2 Ω
Fs	29Hz
Mms	183g
Cms	0.15mm/N
Vas	50l
Qts	0.46
Qes	0.49
Qms	6.1
Bxl	21.3 N/A
Sd	502cm ²
SPL	87dB
Xmax	22.5mm

MECHANICAL DRAWING

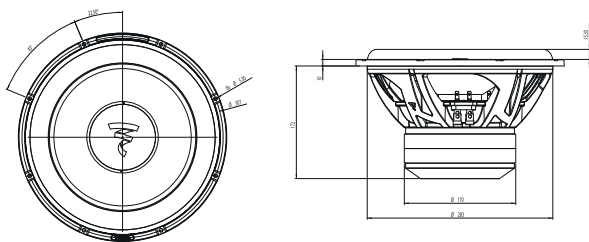

SUGGESTED APPLICATION

Sealed enclosure

Volume	F-3 (Hz)
28L 0.35 cu.ft.	45Hz
35L 0.52 cu.ft.	41Hz

Ported enclosure

Volume	F-3 (Hz)	Ø event Ø port	LG event Port length
28L 0.88 cu.ft.	35Hz	8cm 3 ^{5/32"}	40cm 13 ^{25/32"}
50L 1.05 cu.ft.	30Hz	10cm 3 ^{15/16"}	40cm 15 ^{3/4"}



Elite
"HAUTE COUTURE" SOUND



FOCAL
THE SPIRIT OF SOUND